

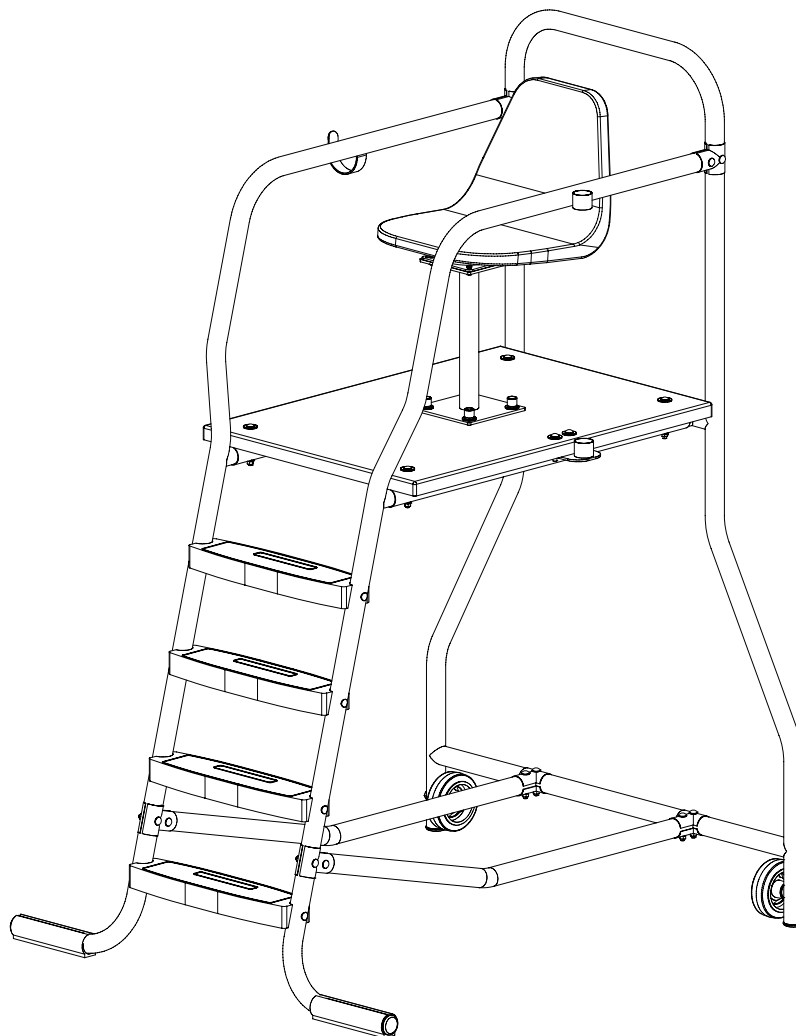

VISTA™ MOVEABLE LIFEGUARD CHAIR

ASSEMBLY INSTRUCTIONS



Rainbow Pool Products

PO Box 2388, Mansfield Qld 4122

Telephone STD 61-7-3849 5385

Facsimile STD 61-7-3849 5384

Email: info@rainbowpoolproducts.com.au

Web: www.rainbowpoolproducts.com.au

INTRODUCTION

The Vista™ Moveable Guard Chairs are designed for use on commercial pools where more than one location is desired for one chair. Proper and complete assembly, use, and maintenance are essential for proper operation and to reduce the risk of accident or injury.

****IMPORTANT****

Check entire box and inside all packing materials for parts. Before beginning assembly, read the instructions and identify parts using the figures and parts listed in this document. It is critical that all parts be carefully inspected by the installer prior to installation to ensure that no damage occurred in transit and that a damaged part is not used. Proper installation cannot be overstressed, as an improper installation voids S.R. Smith's warranty and may affect the safety of the user.

**VISTA 6'
US48500**

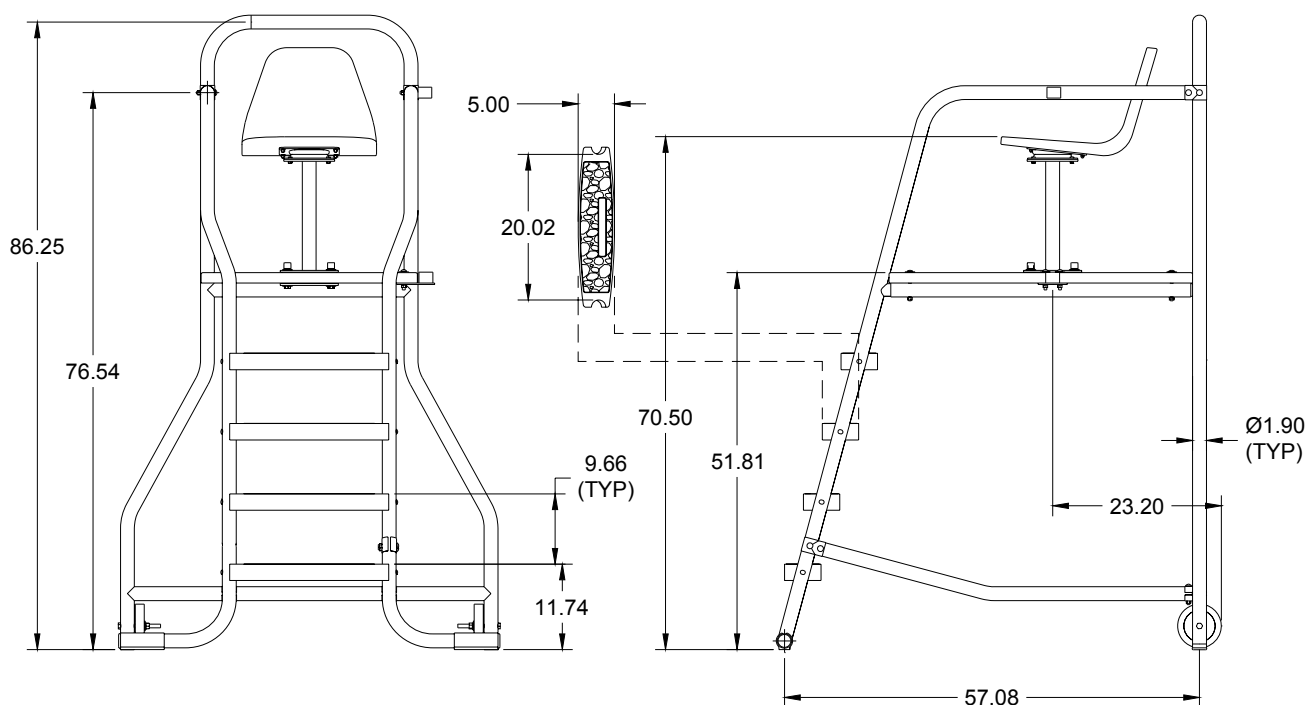
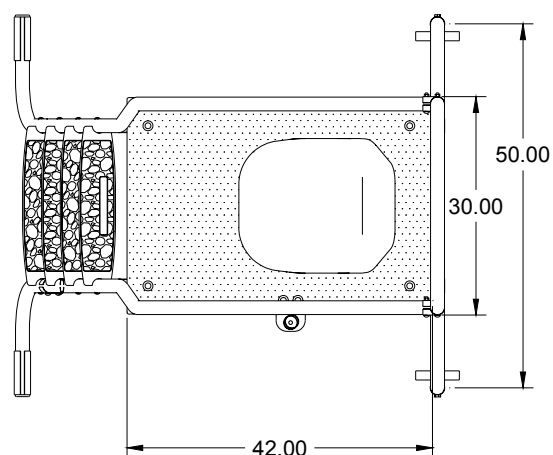

FIGURE 1

VISTA 8'
US48550

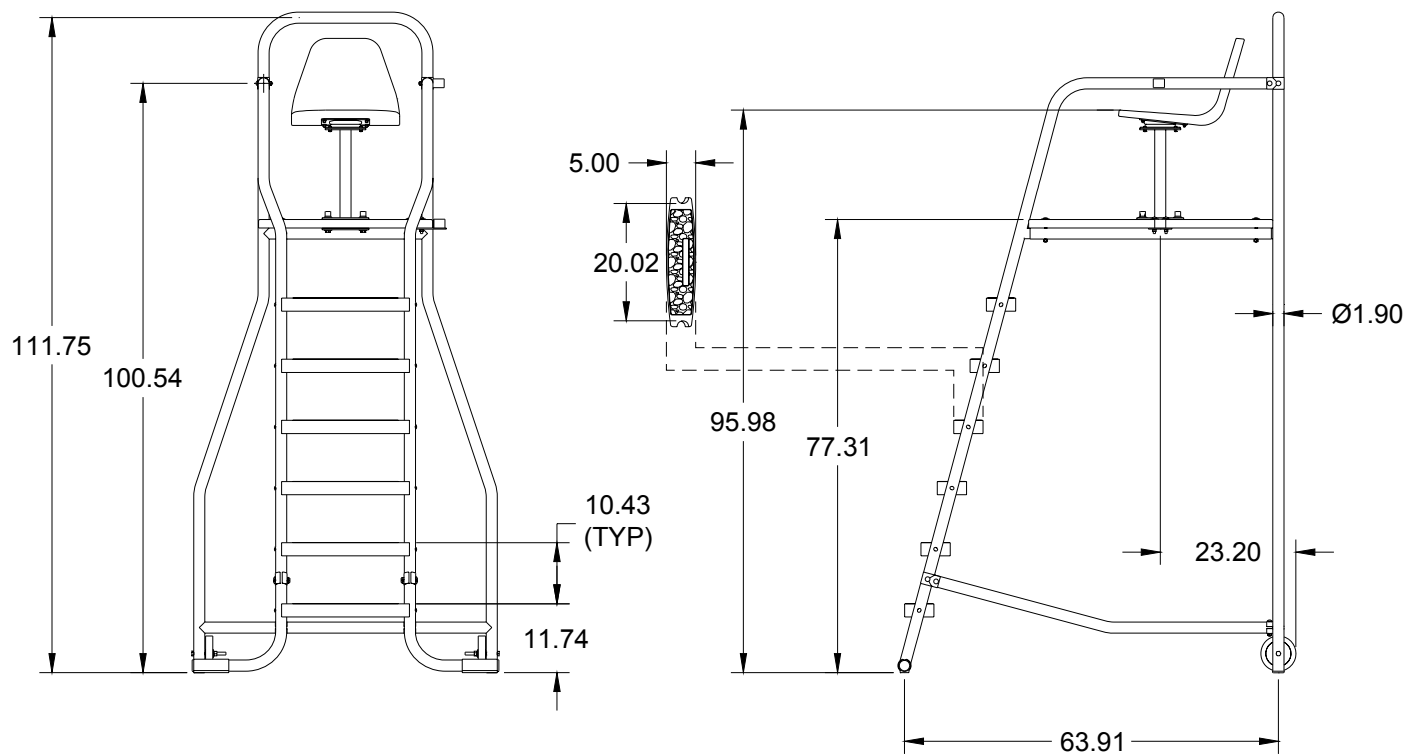
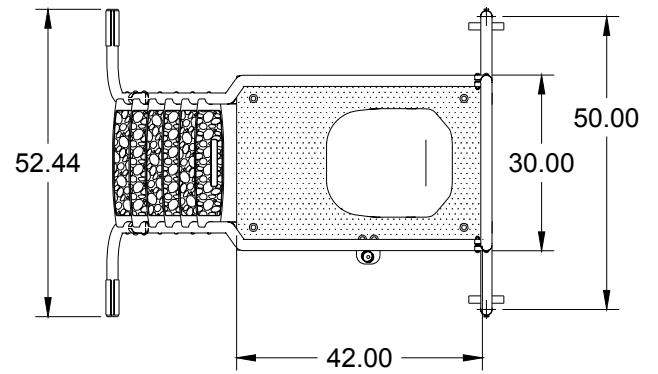

FIGURE 2

VISTA PARTS LIST

ITEM NO.	QTY.	PART NO.	DESCRIPTION
1	1	8-609	LIFEGUARD SEAT
2	1	2407030	SWIVEL, LIFEGUARD CHAIR
3	1	8-612	FOOTBOARD, 30" X 42"
4	2	8-510	GASKET, 7-1/2" X 7-1/2"
5	1	13-117	SWIVEL STAND, W/O UMBRELLA HOLDER
6	1	20-202	SWIVEL STAND MOUNTING PLATE
7	2	FC-100C	10" FULCRUM COVER W/ SLOT
8	1	20-116	UMBRELLA HOLDER ASSEMBLY
9	18	05-14-114	FLAT WASHER, 1/2", SS
10	2	5-117	1/2" X 5-1/2" BOLT, S/S
11	4	5-124	BOLT, 1/2" UNC X 3.0 LG
12	6	05-14-115	LOCK WASHER, 1/2", SS
13	6	05-14-116	1/2" HEX NUT S/S
14	4	05-618	NUT CAP, 1/2", WHITE PLASTIC
15	4	2300300	CARRIAGE BOLT, 3/8" UNC X 4" LONG, SS
16	14	2020049	CARRIAGE BOLT, 3/8" UNC X 2-1/2" LONG, SS
17	6	5-151	LOCK WASHER, 3/8", SPLIT, SS
18	26	5-139	3/8" UNC, HEX NUT, SS, 6FT VISTA
18	30	5-139	3/8" UNC, HEX NUT, SS, 8FT VISTA
19	2	5-149	LOCK WASHER, 1/4", SPLIT, SS
20	2	5-137	HEX NUT, 1/4" UNC, SS
21	1	2024189	SCREW, 1/4" X 3/4" LG, PAN HD, SLOTTED, SS
22	1	20-121	REAR FRAME ASSEMBLY, 6FT VISTA
22	1	20-135	REAR FRAME ASSEMBLY, 8FT VISTA
23	2	20-124	FRONT CROSS TUBE, VISTA
24	2	20-125	BOTTOM RAIL, 6FT VISTA
24	2	20-138	BOTTOM RAIL, 8FT VISTA
25	1	20-122	LEFT FRONT RAIL ASSEMBLY, 6FT VISTA
25	1	20-136	LEFT FRONT RAIL ASSEMBLY, 8FT VISTA
26	1	20-123	RIGHT FRONT RAIL ASSEMBLY, 6FT VISTA
26	1	20-137	RIGHT FRONT RAIL ASSEMBLY, 8FT VISTA
27	4	2350105	TREAD, WHITE, 15 DEGREE, 6FT VISTA
27	6	2350105	TREAD, WHITE, 15 DEGREE, 8FT VISTA
28	8	5-145	FLAT WASHER, 3/8", SS, 6FT VISTA
28	12	5-145	FLAT WASHER, 3/8", SS, 8FT VISTA
29	8	5-167	CRADLE HEAD BOLT, 3/8" X 3-1/4" LG, SS, 6FT VISTA
29	12	5-167	CRADLE HEAD BOLT, 3/8" X 3-1/4" LG, SS, 8FT VISTA
30	2	8-862	PLS 6" WHEEL
31	2	8-104	PLASTIC RAIL END PLUG
32	12	2019060	SPLIT TEE HALF, SS

ASSEMBLY INSTRUCTIONS

1. Begin by locating the rear frame, front cross tubes (2), and the split tees as shown in **FIGURE 3**. Attach front cross tubes to the rear frame by sliding over the inserts as shown in **FIGURE 3**. (Do not bolt cross tubes in at this time) Attach (4) split tee halves at the top of the rear frame using (4) 3/8"x2-1/2" carriage bolts and (4) 3/8" hex nuts. **NOTE:** Do not tighten any hardware until final step.

Stand rear frame up and attach both front rails by inserting the top into the split tees already on the rear frame and the stainless inserts into the front cross tubes. See **FIGURE 4**

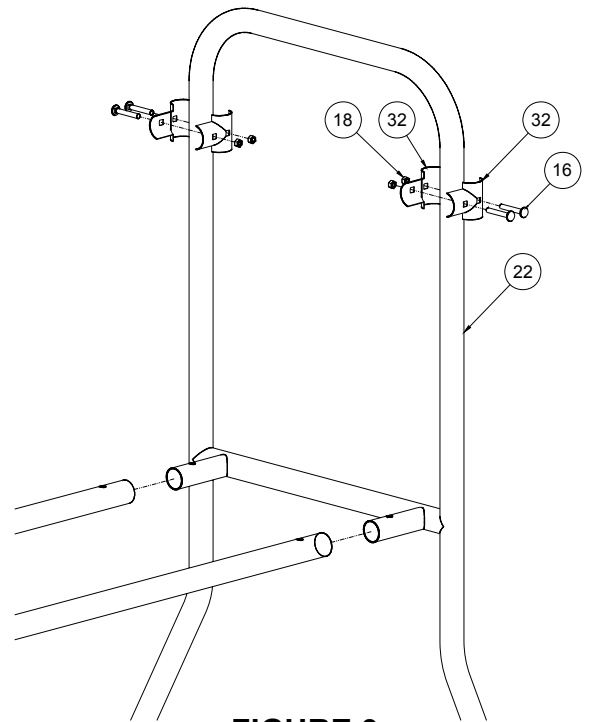

FIGURE 3

2. Attach the four 15° white steps using the supplied pre-packaged hardware. Each step is fastened using (2) 3/8" Cradle head bolts, 3/8" flat washers, and 3/8" hex nuts. See **FIGURE 4**.

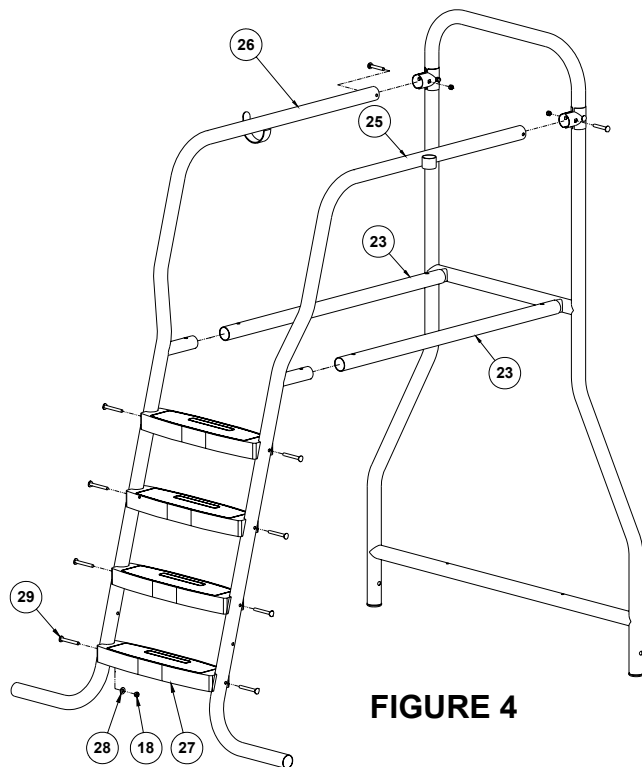

FIGURE 4

3. Attach footboard to both cross tubes using (4) 3/8"x4" carriage bolts, 1/2" flat washers, 3/8" lock washers, and 3/8" hex nuts. Attach the two bottom rails with (8) split tee halves, 3/8" x 2-1/2" carriage bolts and 3/8" hex nuts. See **FIGURE 5**.

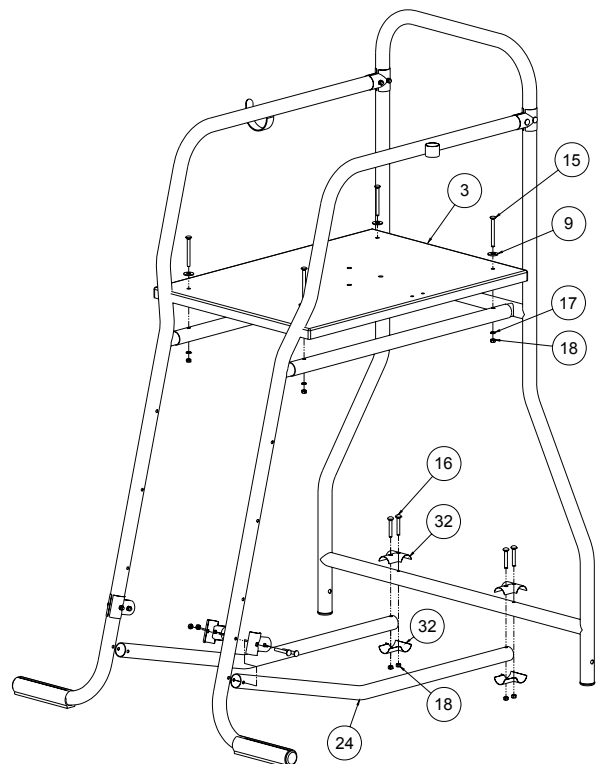

FIGURE 5

4. Place Swivel onto Swivel Stand W/O Umbrella Holder orienting as shown in **FIGURE 6**. Place Screw through Swivel and Swivel Stand (4 places) as shown in **FIGURE 6**. Place 1/4" Lock Washer and 1/4" Hex Nut onto Screw and tighten (4 places).

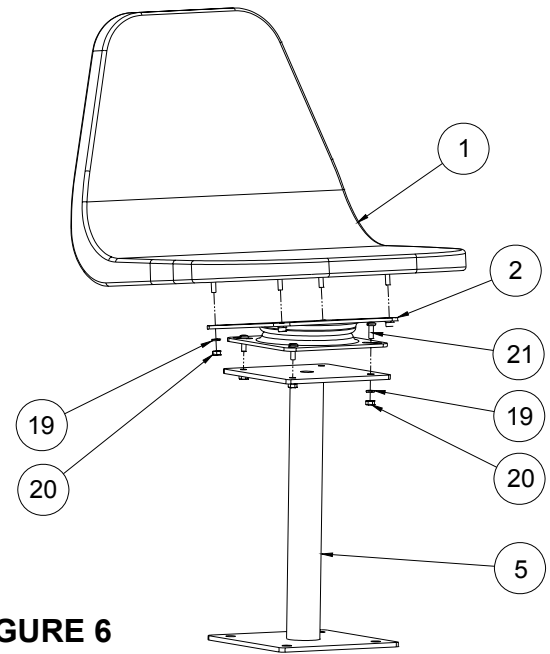
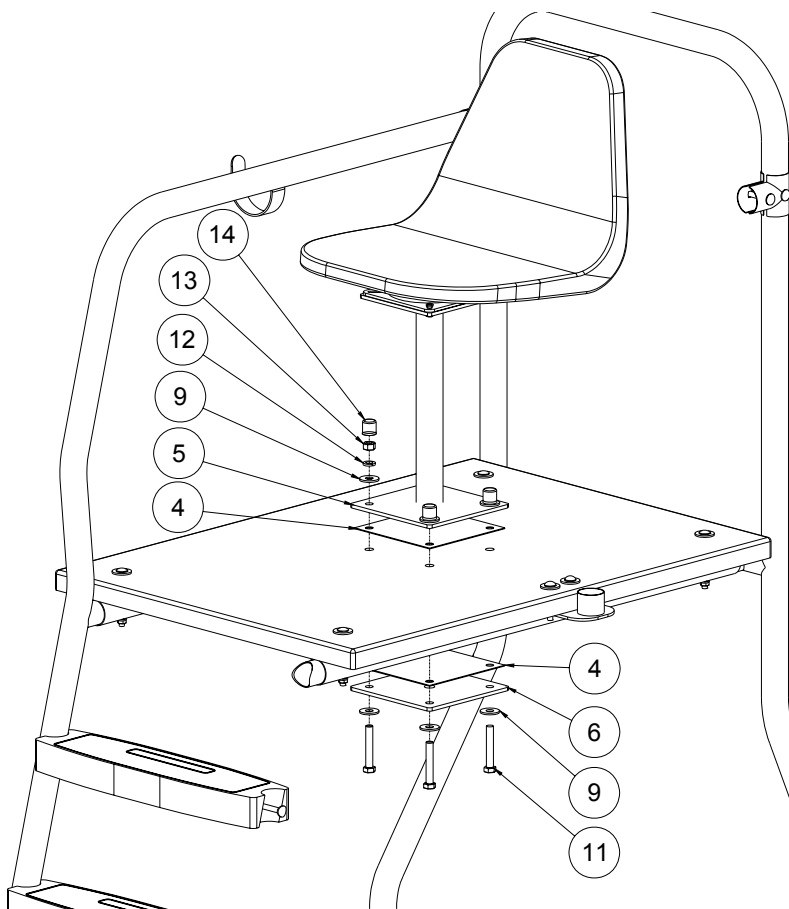

FIGURE 6

5. Attach the seat assembly to the footboard using (4) 1/2"x3" hex head bolts, (8) 1/2" flat washers, (4) 1/2" hex nuts, (4) 1/2" lock washers, (4) 1/2" plastic nut caps and (1) mounting plate as shown in **FIGURE 7**. A rubber gasket is placed both above and below the footboard, in-between the stainless steel plates.



Handrail Removed For Clarity

FIGURE 7

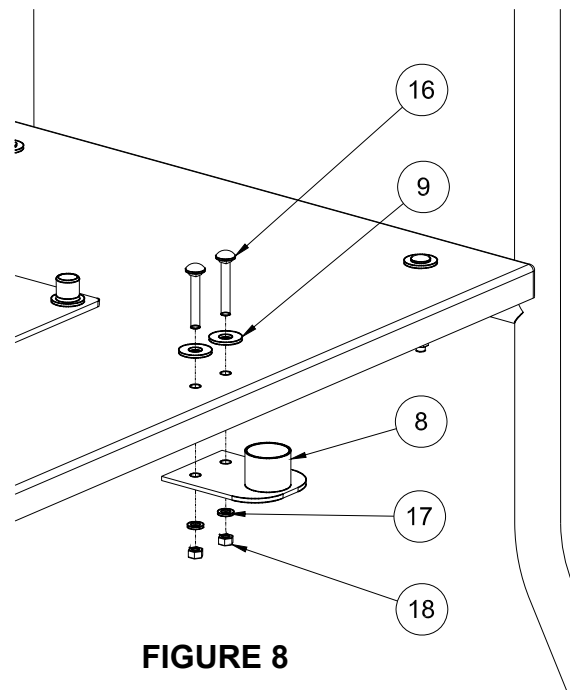

FIGURE 8

6. Attach the umbrella holder using (2) 3/8"x2-1/2" carriage bolts, 1/2" flat washers, 3/8" lock washers and 3/8" hex nuts. See **FIGURE 8**.

7. Install the 6" wheels using (1) 1/2"x5-1/2" hex head bolt, (2) 1/2" flat washers, and (1) 1/2" lock washer and (1) 1/2" hex nut as shown in **FIGURE 9**.
8. Attach the front rubber protective pads and fully tighten all hardware. See **FIGURE 9**.

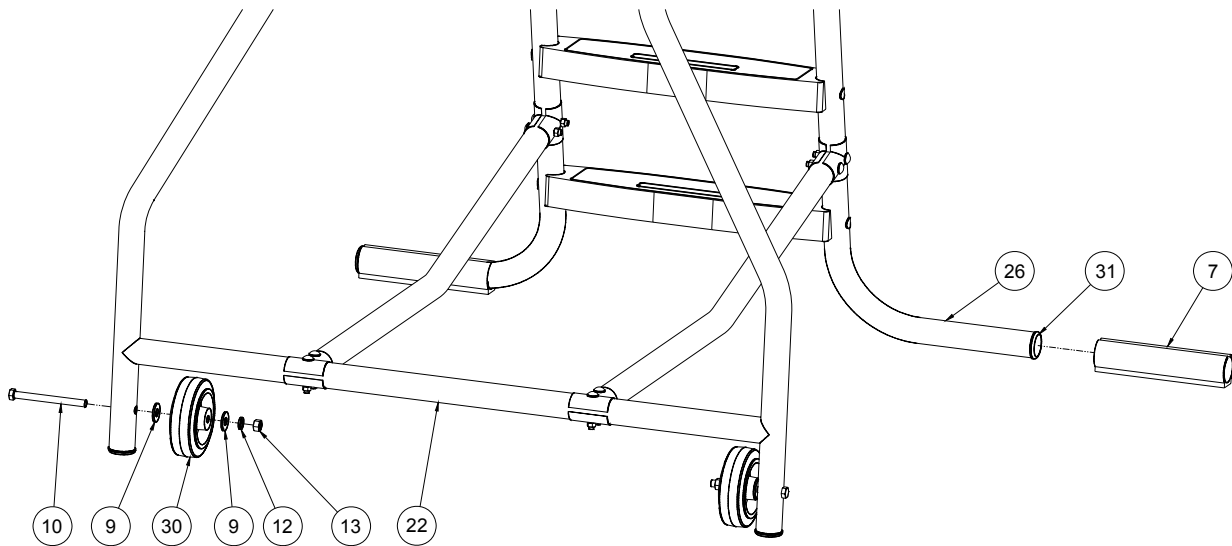

FIGURE 9

SAFETY & MAINTENANCE INSTRUCTIONS

- Do not dive or jump from any part of this guard chair.
- Periodically inspect the VISTA to assure there are no worn parts and that all hardware is properly tightened.
- All stainless steel parts require periodic maintenance. Polishing with a cotton cloth and a Windex-type product maintains the finish and restores luster.
- Use non-abrasive soap and water. Avoid harsh chemicals and disinfectants. Always read the label instructions on any cleaner carefully before applying it to a surface.