



## Rainbow Pool Products

PO Box 2388, Mansfield Qld 4122

Telephone STD 61-7-3849 5385

Facsimile STD 61-7-3849 5384

Email: [info@rainbowpoolproducts.com.au](mailto:info@rainbowpoolproducts.com.au)

Web: [www.rainbowpoolproducts.com.au](http://www.rainbowpoolproducts.com.au)

### SWIM-N-SPIKE & COMMERCIAL VOLLEYBALL ASSEMBLY & INSTALLATION INSTRUCTIONS

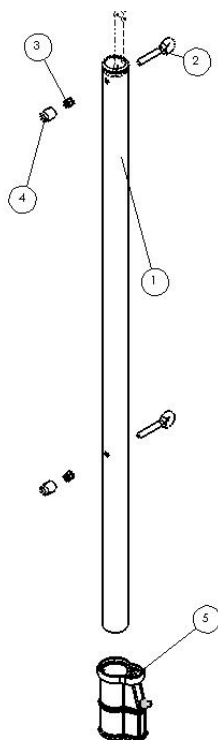

Item	Qty.	Part No.	Description
1	2	20-109	Volleyball Post Ass'y
2	4	5-332	3/8" S/S Eyebolt
3	4	5-141	3/8" Lock Nut S/S
4	4	05-608	3/8" Black Nut Cap
5	2	AS-100P	ANCHOR PLASTIC 1.9" X 4" OR 6"
6	1	VBK-*	Net, Needle & Ball (not pictured)

\*VBK-100 16' NET (for pools 15' to 20' in width)

VBK-101 32' NET (for pools 30' to 36' in width)

VBK-102 42' NET (for pools 40' to 46' in width)

VBK-103 52' NET (for pools 50' to 52' in width)

### SAFETY INSTRUCTIONS

- This equipment is intended for use in shallow water depths.
- During play, do not wear jewelry (rings, watches, necklaces etc.) Objects may entangle in net.
- When removing volleyball posts from anchors place cap in anchor for coverage.

### INSTALLATION INSTRUCTIONS:

1. Volleyball posts are to be anchored in the deck using 6-inch deep Universal Anchor sockets. Install anchors in the pool deck at a location where the game will be played in shallow water depths. Bond anchors as required.
2. Attach the eyebolts to the volleyball posts as shown in the figure above.
3. Place the volleyball posts into the anchors, tighten wedges accordingly. Attach the volleyball net to the eyebolts of the volleyball posts. Ensure any loose rope from the net is properly secured so as to not provide a hazard.
4. Inflate the volleyball to the proper pressure with the needle provided.
5. Ensure caps are placed in the anchors whenever the volleyball posts have been removed.