



Daisy Covers and Rollers are designed to work together smoothly.

*At this stage the cover is trimmed, installed and on the pool water.*

**1 Centre assembled roller to pool**  
(roller is approx 150mm wider on each end). Align cord attachment (Feather Plugs) on the tube and mark about 100mm in from the end cut of the pool cover and punch a hole with the eyelet-punch supplied.

**2 Install eyelets.**  
Place the male half of the eylet under the punched hole and female half on the top. Tap together on the ground.

**3 Secure cord to cover and roller.**  
Tie a loop at one end and attach to Feather Plug on roller.

Thread other end through cover eyelet and tie off to cord adjuster or Bowline knot.

**4 Repeat for all cord attachments.**  
If your pool has a curved end then you may only need to use 3 or 4 anchoring points.

**5 Adjust the cords**  
with the cord adjuster so that the cover comes onto the roller tube evenly. Start from the centre and work out to the ends on both sides aiming to set cords to retrieve evenly.

Minor adjustments may be needed to fine tune the settings for smooth cover recovery.

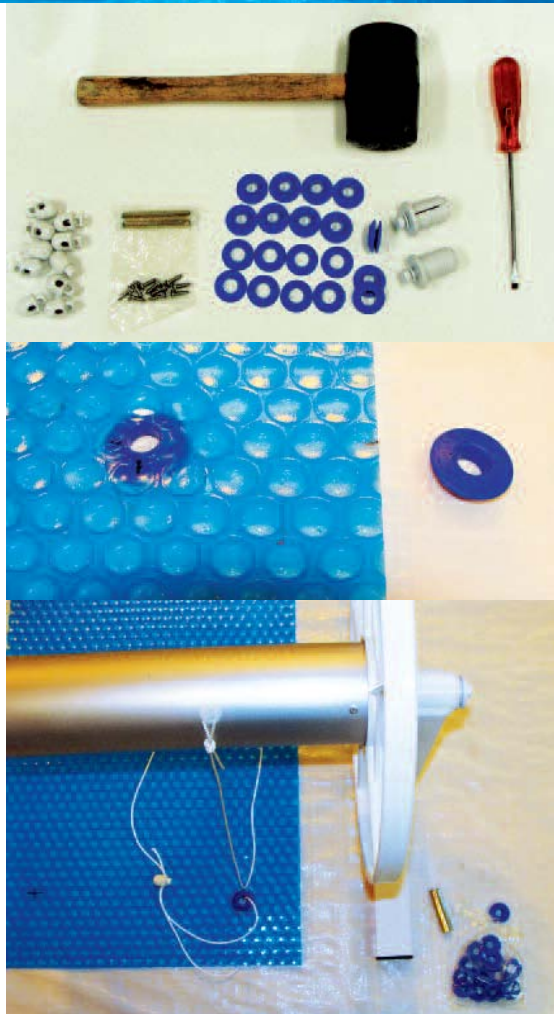

## Rainbow Pool Products

PO Box 2388, Mansfield Qld 4122

Telephone STD 61-7-3849 5385

Facsimile STD 61-7-3849 5384

Email: [info@rainbowpoolproducts.com.au](mailto:info@rainbowpoolproducts.com.au)

Web: [www.rainbowpoolproducts.com.au](http://www.rainbowpoolproducts.com.au)

5★

# Daisy Saves

The quick and easy way to assemble a roller and pool cover.



Installing  
5 Star Roller  
& connecting  
a Daisy Cover

daisy  
pool covers & rollers

# 5 Star Roller Installation

A75 – ST – MKII – LP – L100 – FM –  
CJ 100 - AGA 125ST – 125FM - Maxi

*Note: There are two tube styles –  
Fixed length and Expandable tube.*

**1 After carefully unpacking, start by  
placing the tube evenly across one end  
of the pool. (Deep end or roller location)**  
*See Illustration picture 1 below*

**2 FM & LP models only - insert the castor  
wheels to the underside of the  
frame. With castors on the ground, tap  
the castor nut down through the frame  
with a soft  
hammer until they click together.**  
*See Illustration 2*  
**Assemble roller system.**

**3 Slide the handwheel over the end  
slug – align holes, insert stainless steel  
screws (6) and tighten.**  
**Repeat for other end.**

**4 Slide frame onto the end slug shaft.**

**5 Insert end plug into End Slug Shaft.**  
**Finger tighten Bolt Head Nut only.**

**Frame and tube are now assembled.**

**6 Attach “cut to shape” cover to roller.**

**At this stage the Daisy pool cover is  
installed trimmed and ready on the pool  
water.**

**See page 4**

*Note: Each end may differ*

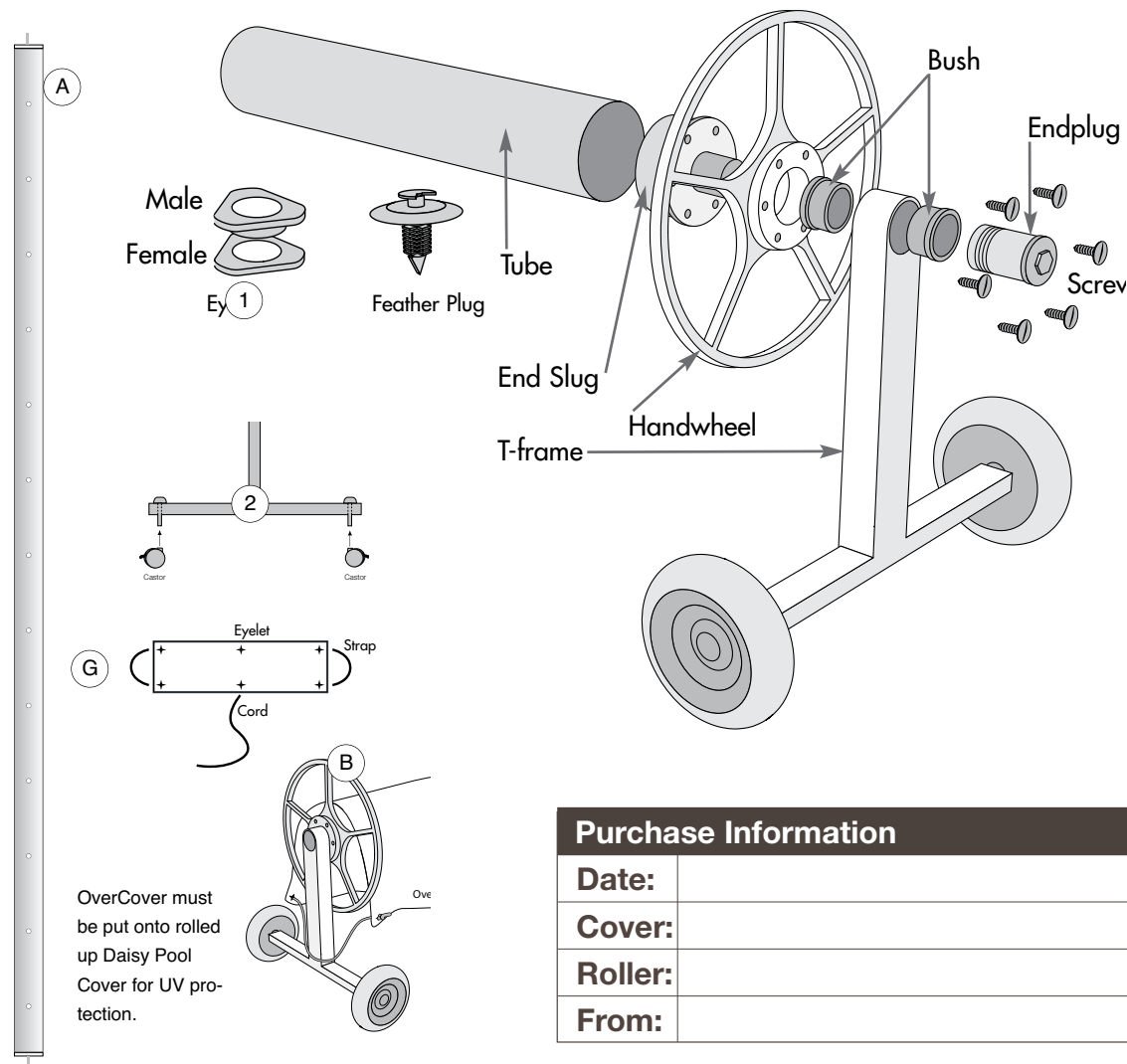

## 5 Star Daisy Roller Kit

- A - One Tube  
*End Slugs & Feather Plugs  
pre assembled*
- B - Two Handwheels
- C - Two End Frames  
*Bush's pre Assembled*
- D - Two End Slugs *pre Installed*
- E - Twelve Screws
- F - Two End Plugs
- G - One OverCover

FM - Four Casters  
LP - Four Casters  
MKII - Two Wheels  
Maxi - Four Casters  
All Stationary Roller - Skid Pads

## Cover Connection Kit

- 1- Ten Eyelets  
*Ten male / Ten female*
- 2 - One Eyelet Punch
- 3 - Ten Spring Loaded Adjusters
- 4- Ten 2metre Cords

- Equipment Needed**
- Rubber Mallet
  - Screwdriver - Phillip Head
  - Block of wood (for hole punching)

## Purchase Information

<b>Date:</b>	
<b>Cover:</b>	
<b>Roller:</b>	
<b>From:</b>	

6

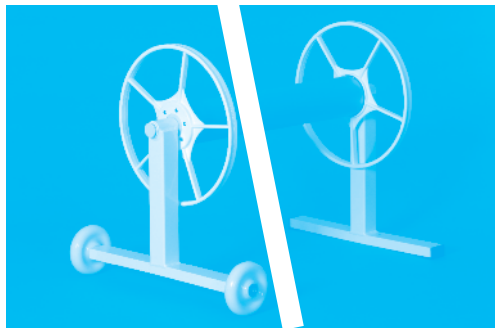

Start assembly at the end where roller is to be located.



Step 3-Slide handwheel onto end slug



Locate roller at opposite end of extended area - Fold over to roll up.

