



POOL PRODUCTS
Quality Pool & Spa Products

PORTAPAC ELECTRONIC

(Product Code: 4555130E, 132, 133, 134, 135E, 136, 137E, 138, 139)

SPARE PARTS DIAGRAM

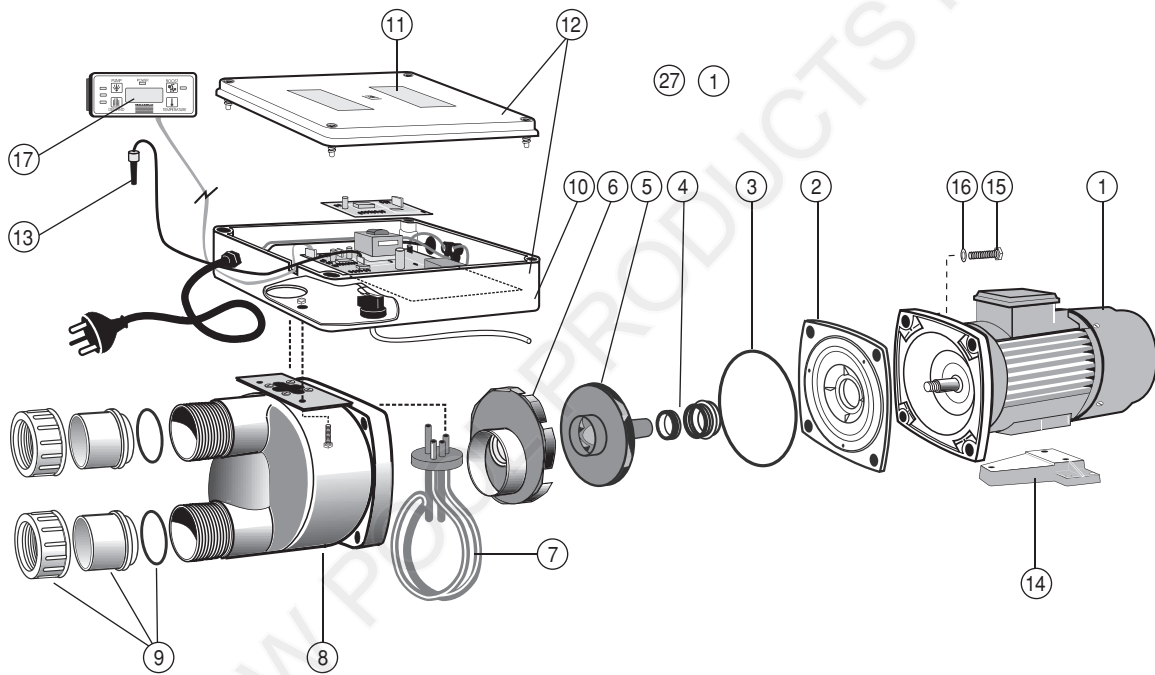

Key	Description	Product Code
1	Motor 1.17kW	6307245
2	Adapter Plate	S132891
3	O ring	S1226911
4	Mechanical Seal	6340162
5	Impeller (suit 133, 135E, 136, 137E, 139)	S13308E1
5	Impeller (suit 130E, 132, 134, 138)	S13307E1
6	Diffuser	S1295611
7	Element 2.4kw (suits 133, 135E, 136, 137E, 138)	S13869A
7	Element 1.6kw (suits 130E, 132, 134, 139)	S13868A
8	Pump Face Body	S134461
9	Half Union 50 x 40mm	S13185A
10	Control Box Bottom	S138621
11	Control Box Lid	S138631
12	Control Box Assembly Complete (suits 135E, 130E)	638141AP
12	Control Box Assembly Complete (suits 134, 136)	6381614
12	Control Box Assembly Complete (suits 132, 133)	6381615
12	Control Box Assembly Complete (suits 138, 139)	6381616
13	Temperature Sensor (suits 638162)	64130031
13	Temperature Sensor MK2 (suits 6381620)	64130032
14	Pump Foot	AXPU158
15	M8 x 40mm Bolt	S1160915
16	5/16 x 5/8 Washer	S0013815
n/s	M8 Nut	S0690915
n/s	M6 X 20mm Bolt	634004
n/s	Flinger	S121671
n/s	Brass Shim	S122863
n/s	Profile Washer	63813899
n/s	Element O ring	63813920
	Washer	S0889015
	M4 x 16mm Screw	634036
n/s	Pressure Switch	6367237
n/s	Remote Sensor Housing Assembly (pre 2005)	638162
	Remote Sensor Housing Assembly	6381620
n/s	Gulf Stream Plug	86172
n/s	Sensor Suction Pipe Fitting (no sensor)	6413002
	M4 x 25mm Screw	634037
	O/T Sensor MK2	638172
17	Touch Pad Complete (suits 130E, 132, 133 and 135E)	455512611
17	Touch Pad Complete (suits 134 and 136)	45551285
17	Touch Pad Complete (suits 138 and 139)	455512812
	Conversion Kit - 4555137 To 137E (includes control box, touch pad & sensor)	638161
	Conversion Kit - 4555130/135 To 130E/135E (includes control box, touch pad & sensor)	638161AS