

AQUASTAR

Automated Multiport Valve



Aquastar provides automated backwashing and rinsing, triggered by a pressure sensor, timer, or both. The controller switches off the filter's pump prior to each repositioning of the multiport valve, ensuring safe operation.

- Clear display of valve position
- Quiet operation
- Quick conversion from automatic to manual operation*
- Emergency handgrip integrated in the actuator
- IP65 protection
- Side and top mount configurations



AQUASTAR Automated Multiport Valve

AQUA STAR can be quickly converted from automatic to manual operation in case of an emergency.

Easy mounting and dismantling of AQUA STAR without any additional tools:

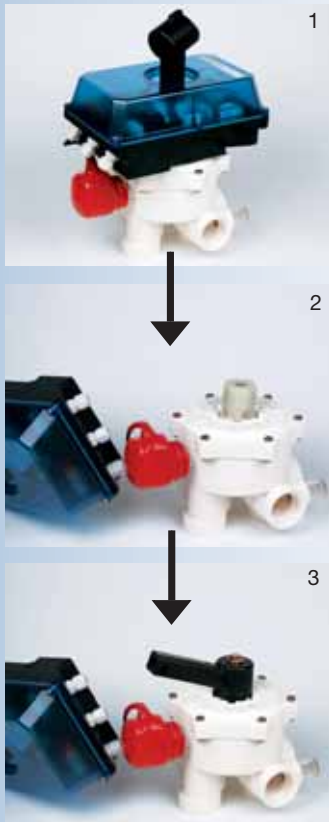

Technical Dimensions

Operating Pressure

ABS 40mm, 50mm	3.5 bar
GFK 40mm, 50mm	6 bar
GFK 80mm	5 bar

Electrical Data

Voltage	230 VAC
Frequency	50/60 Hz
Protective system	IP65

Top Mount configuration



Warranty

AQUA STAR multiport valves are covered by a 1 year warranty

40mm - 50mm

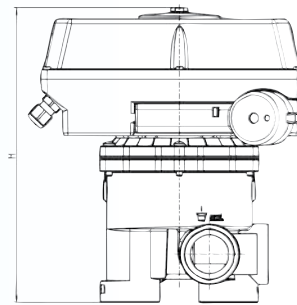

80mm

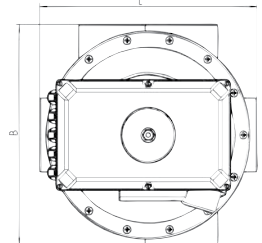
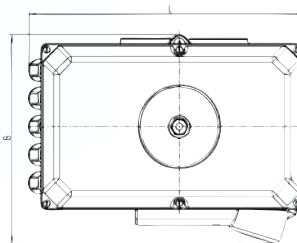
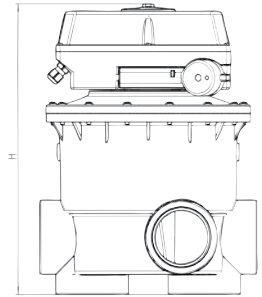

	H	L	B
40mm	294	274	208
50mm	339	274	230
80mm	434	330	330

Types of Control Units

Type	Pressure	Time	Filter Pump Control Unit
E-2000/F2	✓		
E-3000/F2		✓	
E-6000/F2	✓	✓	✓
5000/F2		✓	✓

The pressure sensor and the backwash/rinse timer are adjustable allowing system fine tuning.



Rainbow Pool Products

PO Box 2388, Mansfield Qld 4122

Telephone STD 61-7-3849 5385

Facsimile STD 61-7-3849 5384

Email: info@rainbowpoolproducts.com.au

Web: www.rainbowpoolproducts.com.au