

PRAHER AUTOMATED SIDE MOUNT VALVES



Code	Description
22720040	Motorised MPV 6way E2000 pressure, ABS 40mm
22720050	Motorised MPV 6way E2000 pressure, ABS 50mm
22730040	Motorised MPV 6way E3000 time, ABS 40mm
22730050	Motorised MPV 6way E3000 time, ABS 50mm
22820040	Motorised MPV 6way E2000 pressure, GFK 40mm
22820050	Motorised MPV 6way E2000 pressure, GFK 50mm
22820080	Motorised MPV 6way E2000 pressure, GFK 80mm
22830040	Motorised MPV 6way E3000 time, GFK 40mm
22830050	Motorised MPV 6way E3000 time, GFK 50mm
22830080	Motorised MPV 6way E3000 time, GFK 80mm
22760040	Motorised MPV 6way E6000 press+time, ABS 40mm
22760050	Motorised MPV 6way E6000 press+time, ABS 50mm
22860040	Motorised MPV 6way E6000 press+time, GFK 40mm
22860050	Motorised MPV 6way E6000 press+time, GFK 50mm
22860080	Motorised MPV 6way E6000 press+time, GFK 80mm

Aquastar provides automated backwashing and rinsing, triggered by a pressure sensor, timer, or both. The controller switches off the filter's pump prior to each repositioning of the multiport valve, ensuring safe operation.

Types of Control Units

Type	Pressure	Time	Filter Pump Control Unit
E-2000/F2	3		
E-3000/F2		3	
E-6000/F2	3	3	3
5000/F2		3	3

	H	L	B
40mm	294	274	208
50mm	339	274	230
80mm	434	330	330

Operating Pressure

ABS40mm,50mm	3.5 bar
GFK40mm,50mm	6 bar
GFK 80mm	5 bar

Electrical Data

Voltage	230 VAC
Frequency	50/60 Hz
Protective system	IP65

40mm - 50mm

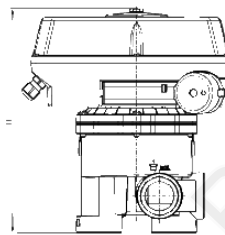

80mm

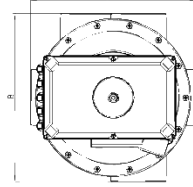
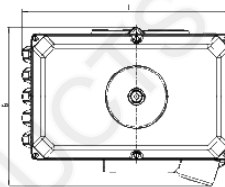
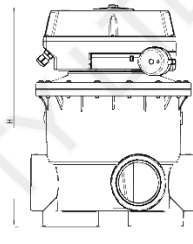

RAINBOW POOL PRODUCTS