

AQUA-STAR POOL LIGHTING SYSTEMS (FIBREGLOSS)



Code	Description
ASL201	Aqua-Star Fibreglass 20m Light only (no transformer)
ASL211	Aqua-Star Fibreglass 1 Pack (single light, 20m cable inc transformer 100VA comes with green and blue coloured lens)
ASL212	Aqua-Star Fibreglass 2 Pack (2 lights, 20m cable inc transformer 100VA comes with green and blue coloured lens)
ASL213	Aqua-Star Fibreglass 3 Pack (3 lights, 20m cable inc transformer 100VA comes with green and blue coloured lens)
ASL214	Aqua-Star Fibreglass 4 Pack (4 lights, 20m cable inc transformer 100VA comes with green and blue coloured lens)
ASL255	Stainless Steel Trim Kit (Includes clear green and blue lens) OPTIONAL EXTRA

FEATURES

The Aqua-Star Pool Lighting System combines many unique features resulting in a spectacular, ultra-reliable lighting system that is user friendly and easy to install. The beauty of the Aqua-Star is that the lights sit flush with the pool wall, making them totally unobtrusive.

The lights are stylish and modern, making them ideal for all types of water features, spas, fountains, water falls, beach areas, ponds and catch tanks. The elegance of the lighting system can be enhanced with the addition of the optional stainless steel trim ring, creating some spectacular visual effects. The Aqua-Star system is supplied with quality cable and industrial strength transformer to ensure maximum light output. The Aqua-Star system is Extra Low Voltage, ensuring safety at all times.

- Stylish, compact and modern design
- Mounts flush with pool wall
- Long life halogen lamp, 12v 50w
- Optional stainless steel trim rings add elegance
- Designed and manufactured in Australia
- Supplied with quick-fit blue and green lenses
- Made to all relevant Australian Standards & Regulations
- Suitable for concrete, vinyl, fibreglass and modular vinyl pools & spas

RAINBOW POOL PRODUCTS PTY LTD

SURFACE MOUNTED POOL LIGHT DIAGRAMS

Aqua-Star Flush Mounted Pool Lights	
Voltage:	12 volt
Wattage:	50 watt
Globe Type:	MR16, 60° beam spread
Cable Lengths & Type:	20m in 2 core, 1.5mm ²
Colour available:	Clear, Blue & Green supplied. Red & Pearl optional.
Applications:	Vinyl & Fibreglass
Optional Extra:	Stainless Steel Trim Ring Kit
Rated:	IPX8, pressure watertight
Complies:	AS/NZS 3000, pressure watertight requirements.
Transformer Options:	
Weatherproof Enclosed Transformer, rated IP65 or	
Splash Proof Plug -In Transformer, rated IP64.	
Input:	240 volt
Output:	12 volt a.c
Available in 12v 100va and 12v 200va	
When connected in parallel:	
The 100va transformer will run up to 2 x Aqua-Star 12v 50w lights.	
The 200va transformer will run up to 4 x Aqua-Star 12v 50w lights.	

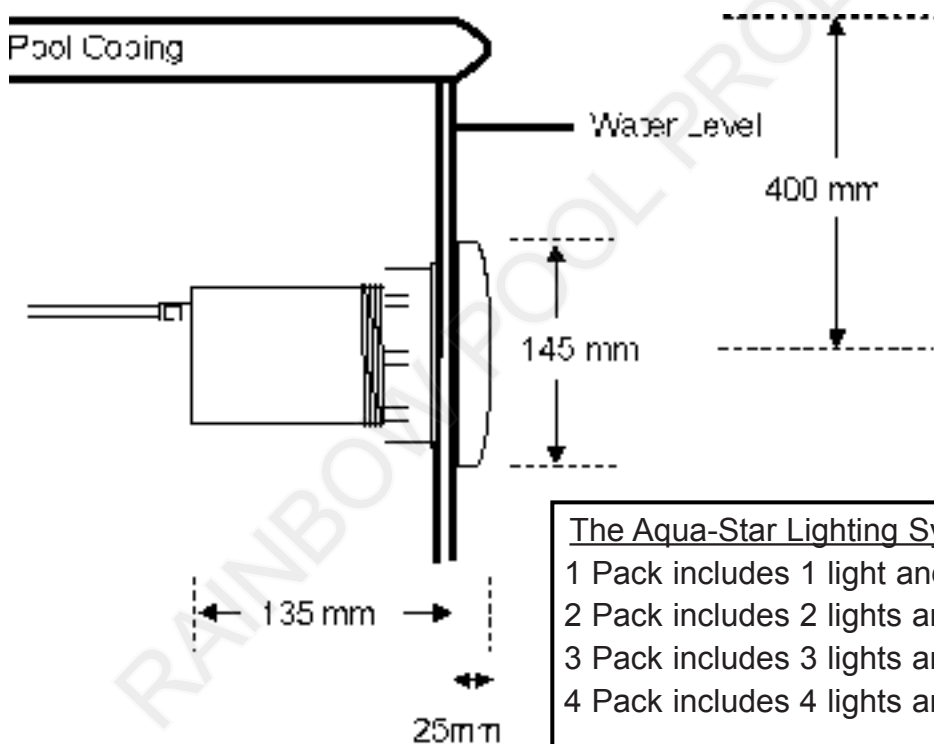

The Aqua-Star Lighting System is available in pack from:

- 1 Pack includes 1 light and a 12v 100va Transformer
- 2 Pack includes 2 lights and a 12v 100 va Transformer
- 3 Pack includes 3 lights and a 12v 200va Transformer
- 4 Pack includes 4 lights and a 12v 200va Transformer

Locate Pool Light in an accessible location for future servicing.

When installed correctly the front face fo the pool light will project out from the pool wall by:
8mm with Standard Clear Diffuser, 10mm with Coloured lens, 13mm with Stainless Steel Trim Ring.

FIBREGLASS / VINYL POOL - INSTALLATION INSTRUCTIONS

- 1) Drill a 102mm (4") diameter hole in the pool wall where the light is to be located, the centre of the hole should be 40cm below the top of the finished pool coping. Choose a flat surface. If pool is vinyl lined, cut similar hole in vinyl using knife. Contact Aqua-Quip for suppliers of 102mm hole saws.
- 2) Feed the light cable through the hole in the pool wall, fit the pool light housing into the hole, and push the white rubber gasket and housing up against the pool wall.
- 3) Behind the pool, pass the cable through the cork gasket and locking ring provided.
- 4) fit the cork gasket onto the housing, and push it up against the rear of pool wall.
- 5) Ensure the threads on the housing and locking ring are clean of sand and debris.
- 6) Screw the locking ring onto the housing and tighten it up against the cork gasket, using a "strap wrench" around the locking ring.
- 7) Screw on coloured lenses and/or polished stainless steel trim ring if required. To fit coloured lens, remove the 2 screws securing the light, position lens over the light and secure lens and light using the longer 3/4" screws supplied with the lenses. Stainless steel trim ring fits over the coloured lens also using the 3/4" screws.
- 8) Only turn pool light on when completely submerged under water.

GLOBE CHANGING INSTRUCTIONS

- 1) Unscrew the 2 stainless steel screws, remove stainless steel trim ring and/or coloured lens if fitted and float the light to the surface.
- 2) Grip the rear nut with multi grips or use a screwdriver through the two holes in the black nut and ¼ turn anticlockwise to remove the nut from the body, exposing the globe.
- 3) Remove existing globe by gently pulling the top of the reflector, do not pull on the glass. Replace the globe using a 12v 50w MR16 Globe, 55-60 degree beam. Never touch the glass when replacing the globe.
- 4) Replace and lubricate the nut o-ring. The replacement and lubrication of this o-ring is necessary any time the Aqua-Star light is disassembled. Only use silicone based lubricants.
- 5) If ceramic lamp holder is damaged or corroded, then it should be removed using long nosed pliers. The male spades of the new ceramic lamp holder will push into the female spades. Replacement ceramic lamp holders are available in kit form, see over page.
- 6) To re-insert nut into body. Place body onto folded towel on ground with clear diffuser facing down. Align the mark on the nut with the alignment mark on the body, firmly push nut into body and ¼ turn clockwise.
- 7) Excess cable can be loosely wrapped around the body and/or inserted into the rear of the housing.
- 8) Remount the light (& coloured lens and stainless steel trim ring if fitted) to the dress ring using the 2 stainless screws.



Use a 4" (102mm) hole saw and drill a hole for the pool light at a maximum depth of 400mm below the top of the finished deck level.



Firstly ensure that there is a flat surface at the rear of the fibreglass shell so that the lock ring will tighten up properly with the use of a strap wrench (available through Aqua-Quip).

Use the supplied cable gland and run the low voltage cable directly to the transformer. Alternatively, remove the cable gland and glue on a 20mm electrical coupling if conduit is being used.



A rubber gasket is pre-fitted behind the flange and will seal against the pool wall. A small amount of silicone sealant may be used on the gasket prior to tightening the rear nut. Aqua-Star light mounts onto 2 of these screw hole provisions.



The Aqua-Star pool light is compact and sits unobtrusively on the wall of a fibreglass pool.

DIAGRAMS

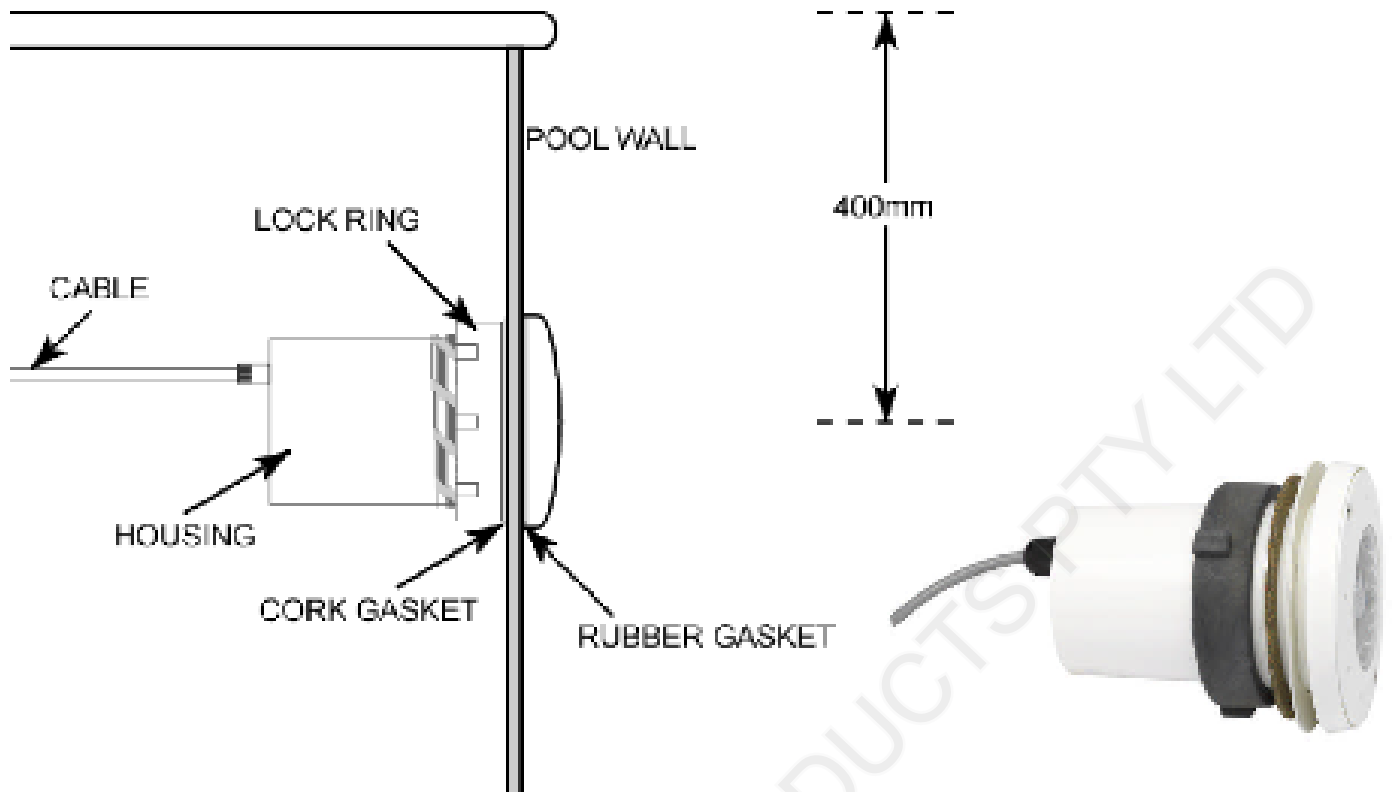

SPARE PARTS

P/N	Description
1	Housing
2	Nut Assembly Kit
3	Nut O-Ring
4	Ceramic Lamp Holder
5	Dress Ring

P/N	Description
6	Globe, 12v 50w MR16
7	Lens Carrier & Diffuser
8	Lens Cover
9	Optional Stainless Steel Trim Ring Kit
3,4,6	Globe Holder Kit

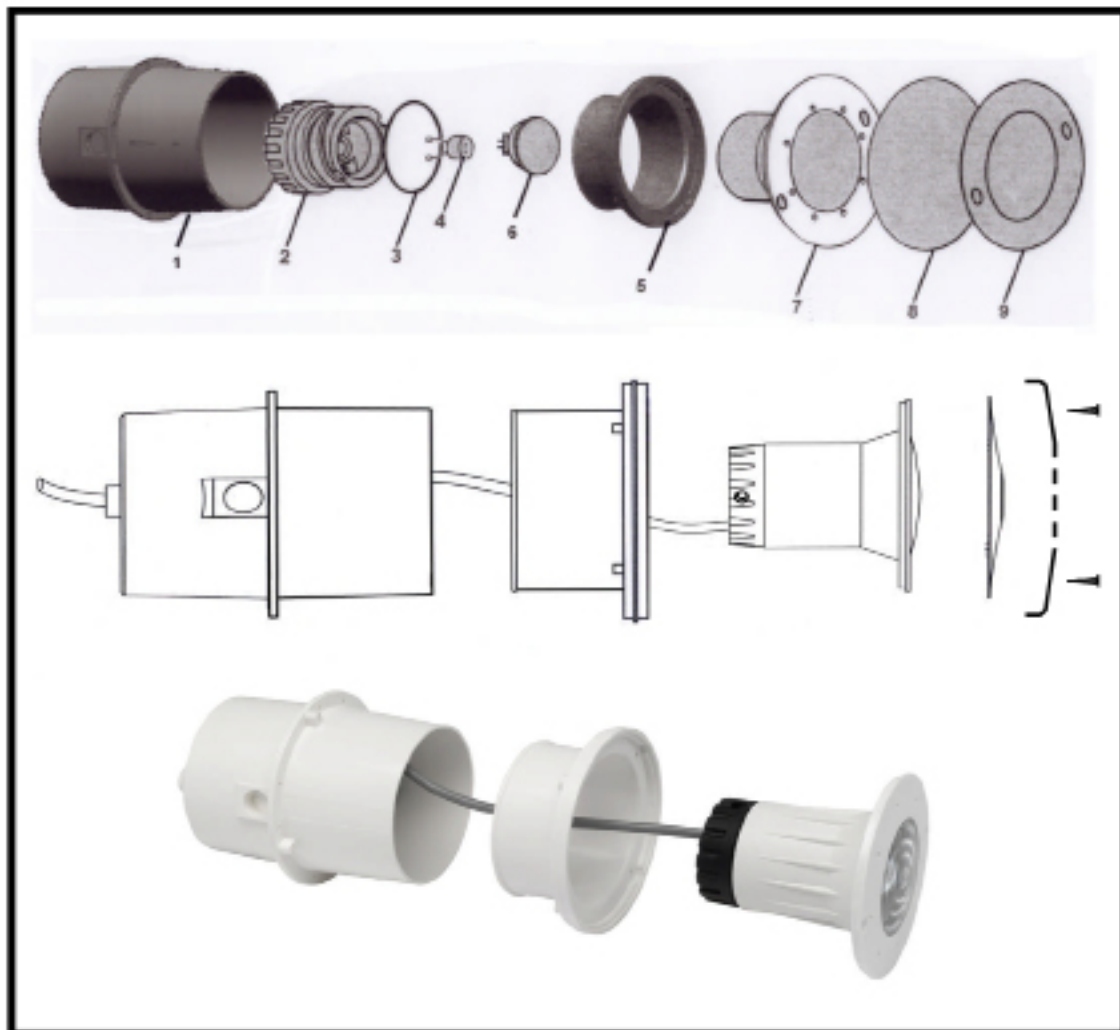

LOW VOLTAGE TRANSFORMERS

Reliable Australian Made toroidal style transformers run quieter, cooler and 35% more efficient than traditional style transformers.

Weatherproof IP65 Range

<u>Description</u>	<u>Order Code</u>
12 volt, 100 VA	APL 300
12 volt, 200 VA	APL 400
24 volt, 150 VA	APL 010
32 volt, 150 VA	APL 041



Splash Proof IP64 Range Supplied with 3-Pin Plug

<u>Description</u>	<u>Order Code</u>
12 volt, 100 VA	APL 301
12 volt, 200 VA	APL 399

